

**Engine Model
CPL**

6CT 8.3

(CDC 6.830)

TURBOCHARGED

Piston Std (m):

3163, 9564, 9928

CUMMINS CPL's

602 828 1274 1603
603 955 1275 9820
753 985 1281
819 1248 1603

CASE-IH (Agricultural)

1660 Combine
1666 Combine, ESN > 44706126 >
1670 Combine, ESN > 44706125
1680 Combine, ESN > 44706125
2044 Cot Picker, ESN > 44706125
2166 Combine, PIN > JJC0180000
7110 Tractor
7120 Tractor
7130 Tractor
7140 Tractor, ESN > 44706125
7150 Tractor, ESN > 44706125
7210 Tractor
7220 Tractor, PIN > JJA0064978
9110 Tractor, ESN > 44706125
9130 Tractor, ESN > 44706125
9210 Tractor
9230 Tractor, ESN > 44706125
9240 Tractor
9310 Tractor, PIN > JEE0036001

CASE (Construction)

721 Loader
721B Loader, PIN > JEE053200
821 Loader
821B Loader, PIN > JEE050601
1150E Crawler
1155E Crawler
1187C Excav, ESN > 44706125
1550 Crawler, ESN > 44706125
9040 Excavator
9040B Excav, PIN > DAC4#2001
W36 Loader

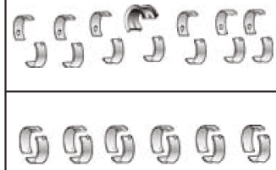
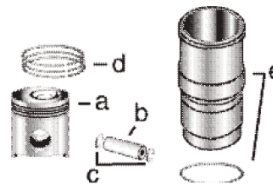

**Engine Overhaul
&
Engine In Frame Kit**

**COK2400
Thin Wall**

**COK2403
Thick Wall Long**

**COK2403S
Thick Wall Short**

**To order an In-Frame
Kit change OK to IK
in above part number**

**Cylinder Kit
Thin Wall (*)**

C3802400

Consists of:

- a) C3923163
- b) C3901597
- c) C3901996
- d) C3802258
- e) C3802370

(C3907792 Liner +
C3907177 Seal)

**Cylinder Kit
Thick Wall (**)
Long Liner**

C3802403

Consists of:

- a) C3923163
- b) C3901597
- c) C3901996
- d) C3802258
- e) C3802407

(C3919937 Liner +
C3907177 Seal)

**Cylinder Kit
Thick Wall (***)
Short Liner**

C3802403S

Consists of:

- a) C3923163
- b) C3901597
- c) C3901996
- d) C3802258
- e) C3800328

(C3948095 Liner +
C3907177 Seal)

Main Bearing Set

Con Rod Bearing

C3802210 Std.
C3802211 0.25 mm
C3802212 0.50 mm
C3802213 0.75 mm

Use 1

C3901430 Std.
C3901431 0.25 mm
C3901432 0.50 mm
C3901433 0.75 mm

Use 12 (1)

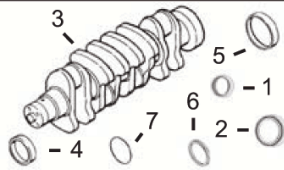

- 1) **Front Seal**
- 2) **Rear Seal**
- 3) **Crankshaft**
- 4) **Front Wear Sleeve**
- 5) **Rear Wear Sleeve**
- 6) **Front Rectangular Seal**
- 7) **Rear Rectangular Seal**

- 1) C3353977
- 2) C3353978
- 3) C3918986
- 4) C3908277
- 5) C3906081
- 6) C3903475
- 7) C3912473

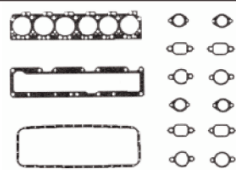

- 1) **Top Gasket Set**
- 2) **Bottom Gasket Set**
- 3) **Head Gasket**
- 4) **Oil Pan Gasket**
- 5) **Valve Cover Gasket**
- 6) **Front Gear Gasket**
- 7) **Front Cover Gasket**
- 8) **Rear Cover Gasket**

- 1) C4025271
- 2) C3800348
- 3) C3938267
- 4) C3914017
- 5) C3905449
- 6) C3929253
- 7) C3917780
- 8) C3914301

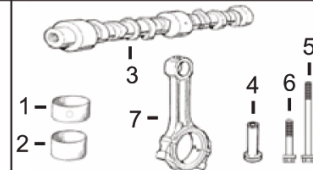

- 1) **Bushing, Piston**
- 2) **Bushing, Camshaft**
- 3) **Camshaft**
- 4) **Tappet**
- 5) **Head Bolt Long**
- 6) **Head Bolt Short**
- 7) **Con Rod**

- 1) C3913990 x6
- 2) C3943199 x7
- 3) C3924471 (2)
- 4) C3925031
- 5) C3917728 x14 (3)
- 6) C3917729 x12 (3)
- 7) C3901383 (4)

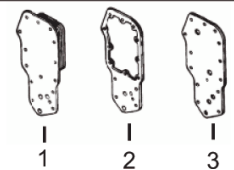

- 1) **Oil Cooler 12 Plate**
- 2) **Oil Cooler Gasket**
- 3) **Oil Cooler Gasket Filter Head**

- 1) C3918175
- 2) C3918174
- 3) C3914308



- 1) **Intake, Valve Kit**
- 2) **Insert, Valve**

- 1) C3802463
- Consists of:
C3924492 Valve x1
C3901177 Collet x2
- 2) C3924582

Use 6

- 1) **Exhaust, Valve Kit**
- 2) **Insert, Valve**

- 1) C3802085
- Consists of:
C3921444 Valve x1
C3901177 Collet x2
- 2) C3924583

Use 6

- 1) **Spring, Valve**
- 2) **Seal, Valve**
- 3) **Guide, Valve**
- 4) **Retainer, Valve Spring**

- 1) C3906412 x12
- 2) C3915707 x12
- 3) C3923564 x12
- 4) C3912976 x12

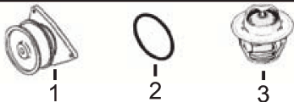

- 1) **Water Pump**
- 2) **Water Pump Seal**
- 3) **Thermostat**

- 1) C3800976 (5) (6)
- 2) C3902089
- 3) C3928639 x2



Oil Pump

- C3930338
(3415365)

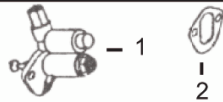

- 1) **Fuel Lift Pump**
- 2) **Fuel Pump Gsk**

- 1) C3917998
- 2) C3914304

(*) Block 3802265 (Thin Wall) Flange ø 5.223".

(**) Block 3802408 (Thick Wall / Long Liner) Flange ø 5.152", (Length: 9.33" / 237 mm).

(***) Block 3934906 (Thick Wall / Short Liner) Flange ø 5.152", (Length: 9.12" / 234 mm).

(1) Order in multiples of two.

(2) To use C3924471 to replace 3917882 buy the following from Cummins: 3918777 Cam Gear, 3927155 Thrust and 3902332 Key.

(3) Only use on engines built from year 1991 onwards.

(4) Do not use with Crankshaft part number 3965006.

(5) Some applications use short nose pump C3806180.

(6) Marine applications use C3800975.